

Technical Data

Parallelism
 $3\mu\text{m}/.0012''$ for models up to 75mm/ 3"
 $(3+R/100)\mu\text{m}$ for models over 75mm,
 R = max. range (mm)
 fraction rounded up
 $.00016''$ for 4" models

Type and Dimensions

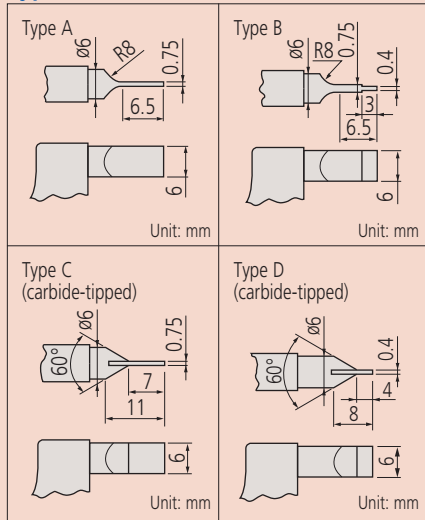

Battery for 422 series

SR44 (1 pc), 938882, for initial operational checks (standard accessory)

Optional accessories

Connecting cables for digital models

1m: **05CZA662**

2m: **05CZA663**

USB Input Tool Direct

USB-ITN-B (2m): **06ADV380B**

Connecting cables for **U-WAVE-T** (digital models)

02AZD790B 160mm

For foot switch: **02AZE140B**

Connecting cables for Quickmike type

1m: **937387**

2m: **965013**

USB Input Tool Direct

USB-ITN-E (2m): **06ADV380E**

Connecting cables for **U-WAVE-T** (Quickmike type)

02AZD790E 160mm

For foot switch: **02AZE140E**

Refer to page A-21 for details.

Quickmike

Provides a speedy spindle feed of 10mm per thimble rotation, which enables widely differently sized features to be measured quickly.

Deviation between the Anvil and Spindle in the Vertical Direction

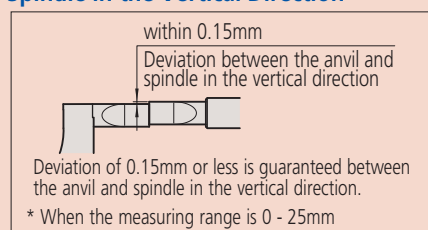

* When the measuring range is 0 - 25mm

Blade Micrometers SERIES 422, 122 — Non-Rotating Spindle Type

- The anvil and spindle are blade-shaped for measuring the groove diameter of shafts, keyways, and other hard-to-reach features.
- Carbide-tipped measuring faces are also available.
- Non-rotating spindle type.
- Equipped with Ratchet Stop for constant measuring force.



Digimatic (LCD)
422-230



122-101



Quickmike Type (LCD)
422-411



ABSOLUTE™

SPECIFICATIONS

Metric						
Order No.	Range	Resolution	Accuracy*	Remark		
Digimatic (LCD)						
422-230	0 - 25mm	0.001mm	±3μm	Type A		
422-231	25 - 50mm					
422-232	50 - 75mm					
422-233	75 - 100mm					
422-260	0 - 25mm		±4μm	Type B		
422-261	25 - 50mm					
422-270	0 - 25mm				±3μm	Type C
422-271						Type D

* Excluding quantizing error

Metric Quickmike type				
Order No.	Range	Resolution	Accuracy*	Remark
Digimatic (LCD)				
422-411	0 - 30mm	0.001mm	±3μm	Type A
422-412	25 - 55mm			

* Excluding quantizing error

Metric				
Order No.	Range	Graduation	Accuracy	Remark
Analog				
122-101	0 - 25mm	0.01mm	±3μm	Type A
122-102	25 - 50mm			
122-103	50 - 75mm			
122-104	75 - 100mm			
122-105	100 - 125mm		±4μm	
122-106	125 - 150mm			
122-107	150 - 175mm		±5μm	
122-108	175 - 200mm			
122-109	200 - 225mm			
122-110	225 - 250mm		±6μm	
122-111	250 - 275mm			
122-112	275 - 300mm	0.01mm	±3μm	Type B
122-111	0 - 25mm			
122-112	25 - 50mm	0.01mm	±3μm	Type C
122-161	0 - 25mm			
122-162	25 - 50mm			
122-141	0 - 25mm			
122-142	25 - 50mm			

Notes: 1) A heat shield is provided with Digimatic models and **422-230** as standard.

Inch/Metric					
Order No.	Range	Resolution	Accuracy*	Remark	
Digimatic (LCD)					
422-330	0 - 1"	.00005"/ 0.001mm	±.00015"	Type A	
422-331	1" - 2"				
422-332	2" - 3"				
422-333	3" - 4"				
422-360	0 - 1"		±.0002"	±.00015"	Type B
422-370					Type C
422-371					Type D

* Excluding quantizing error

Inch/Metric Quickmike type				
Order No.	Range	Resolution	Accuracy*	Remark
Digimatic (LCD)				
422-421	0 - 1.2"	.00005"/ 0.001mm	±.00015"	Type A

* Excluding quantizing error

Inch					
Order No.	Range	Graduation	Accuracy	Remark	
Analog					
122-125	0 - 1"	.0001"	±.00015"	Type A	
122-126	1" - 2"				
122-127	2" - 3"				
122-128	3" - 4"				
122-135	0 - 1"		±.0002"		Type B
122-151					Type D

* Excluding quantizing error

Micrometer

The origin of Mitutoyo's trustworthy brand of small tool instruments

DIMENSIONS

Unit: mm

Digital models up to 50mm measuring range

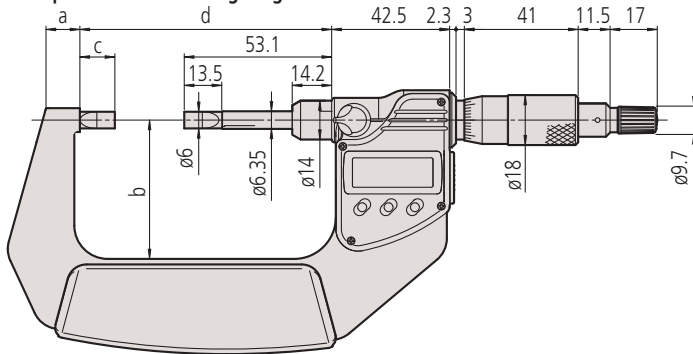

Range	a	b	C	d
0 - 25mm	11	31	12.5	65.6
25 - 50mm	12.2	50	12.6	90.7

Digital models over 75mm measuring range

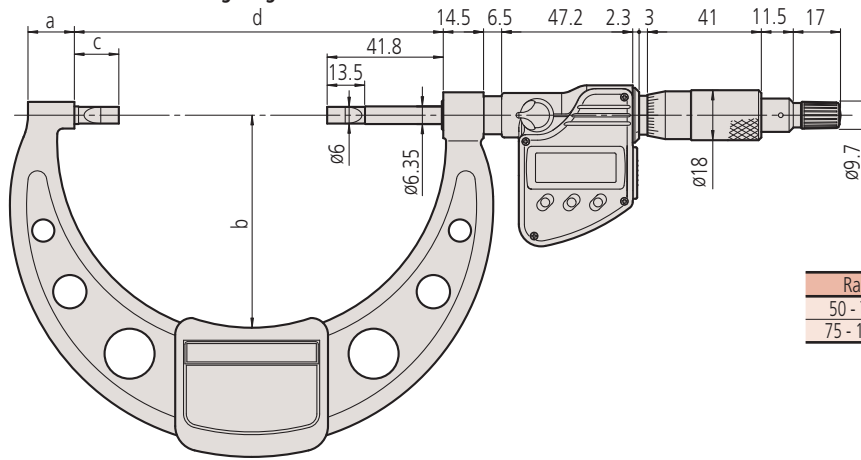

Range	a	b	C	d
50 - 75mm	14.6	57	13	104.8
75 - 100mm	16.7	76	16	132.8

Quickmike type

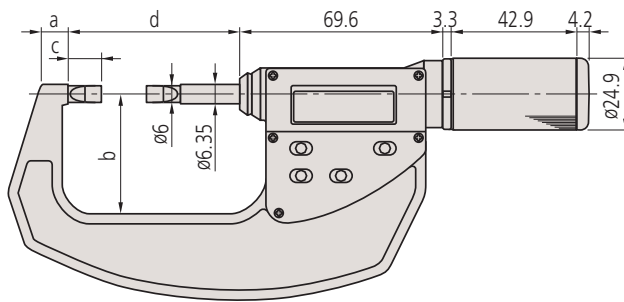

Range	a	b	C	d
0 - 30mm	8.5	36	13.5	59.8
25 - 55mm	10.3	47		84.8

Analog models measuring range

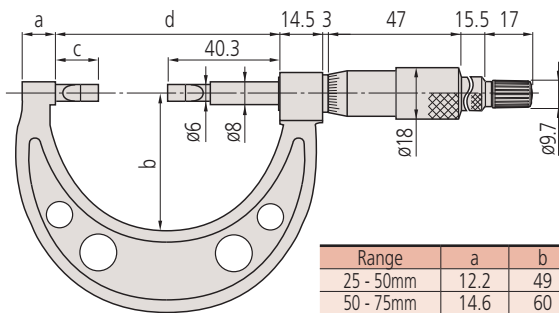

Range	a	b	C	d
25 - 50mm	12.2	49	14.5	79.8
50 - 75mm	14.6	60		104.8
75 - 100mm	17	79	17.5	132.8
100 - 125mm	19	94	17.9	158.2
125 - 150mm	20	106	18.3	183.6
150 - 175mm	19	118	18.5	208.8
175 - 200mm	17	130	18.9	234.2
200 - 225mm	18	143	17.7	258
225 - 250mm		156	18.7	284
250 - 275mm		169	309	
275 - 300mm		181	334	

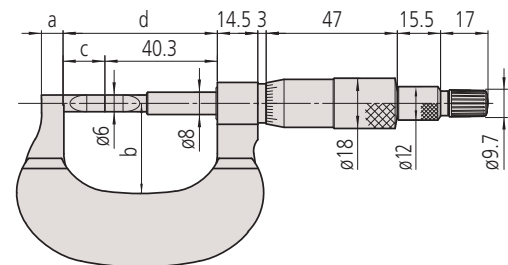

Range	a	b	C	d
0 - 25mm	7.8	32	15	55.3